



732 Ashton Road, Bardsley, Oldham, OL8 3HW
Offers In The Region Of £145,000

MID TERRACE | TWO BEDROOMS | REAR GARDEN AREA | NO CHAIN | IDEAL FIRST PURCHASE | The house on Ashton Road, Bardsley comprises of a lounge, kitchen diner, two bedrooms, bathroom & WC and landing. The outside reveals a forecourt and large rear garden area. VIEWING RECOMMENDED.

ACCOMMODATION

GROUND FLOOR

LOUNGE

15'2 x 14 (4.62m x 4.27m)



KITCHEN DINER

15 x 13 (4.57m x 3.96m)



Single drainer, stainless steel, sink unit. Gas hob, electric oven and extractor. A range of wall and base units.

FIRST FLOOR

BEDROOM ONE

15 x 12 (4.57m x 3.66m)



BEDROOM TWO

10'3 x 10 (3.12m x 3.05m)



BATHROOM & WC

6'8 x 10 (2.03m x 3.05m)



Three piece suite, shower over the bath and shower screen, tiling.

LANDING



EXTERNALLY

SERVICES -

All main services are installed.

IMPORTANT NOTICE -

No checks have been made of any services (water, electricity, gas and drainage) heating appliances or any other electrical or mechanical equipment in this property.

DISCLAIMER -

Wild & Griffiths themselves and the vendors/lessors of this property give notice that these particulars have been prepared in good faith having regard to the property misdescriptions act (1991). Measurements are intended for descriptive purposes only and are believed to be correct but any intending purchasers should not rely on them as statements or representations of fact. Any intending purchaser must satisfy themselves by inspection or otherwise as to the information provided and condition of the property and no warranty is given by the vendor, their agents or any other person in their employment. The property is offered subject to contract and still being available at the time of enquiry and no responsibility can be accepted for any loss or expenses incurred in viewing.

Ground Floor

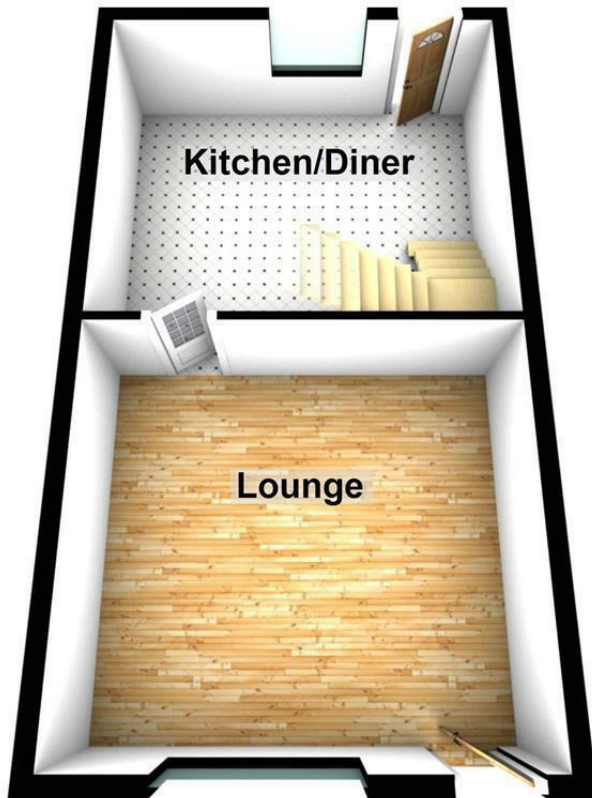

First Floor

